

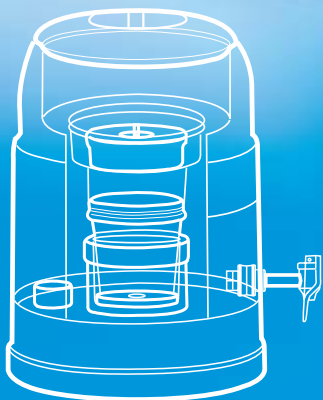

BMP 400

INSTRUCTION MANUAL

“Drink Water
As Nature Intended”



Structure

A

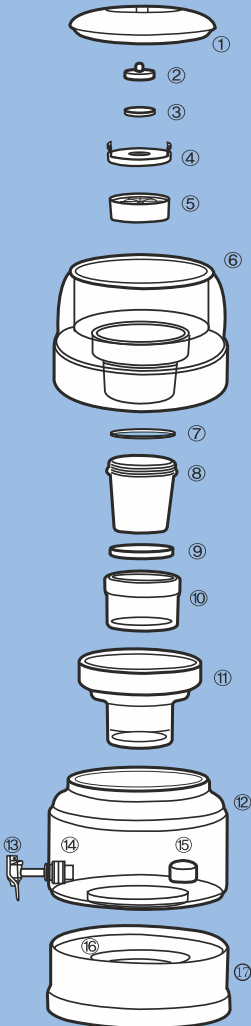

- ① Cap
- ② Micro Cotton Pad Holder
- ③ Micro Cotton Pad
- ④ Upper(1st Stage)Filter Cover
- ⑤ Upper(1st Stage)Filter
- ⑥ Main Funnel
- ⑦ O-Ring
- ⑧ Main Filter
- ⑨ Alkalite Diskette
- ⑩ Bio Ceramic Filter
- ⑪ Bio Ceramic Filter Case
- ⑫ Glass Pot
- ⑬ Tap Outlet
- ⑭ Magnet Outlet
- ⑮ Sub Mineral Cartridge
- ⑯ ND Magnet
- ⑰ Pot Base

How to assemble and use

B

How to rinse the product part
and how to wash the filters

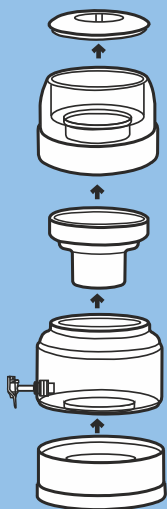

1. Assemble the faucet.



2. Rinse each product parts
separately

3. Drain the water out through
the faucet.

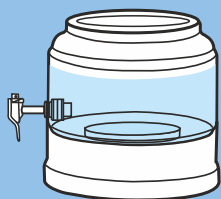

4. Place the glass pot on
the pot base.



5. Take out filters from the filter
box - 1pc each of upper(1st
stage) filter, main filter, bio
ceramic filter, alkalite diskette,
and sub mineral cartridge.
And soak them in the water
container for about 1 hour.

How to assemble and use

C

How to assemble filters



1. After 1 hour of soaking, take out the sub mineral cartridge from the water container and wash it again. After washing, place the sub mineral cartridge in the bottom of the glass pot.

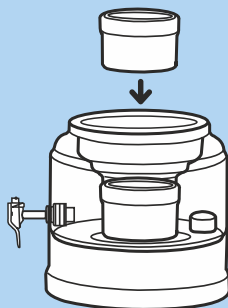

2. Place the bio ceramic filter case on the glass pot as shown.

3. Take out the bio ceramic filter from the water container, and wash it again. After washing, place the bio ceramic filter in the bio ceramic filter case as shown.

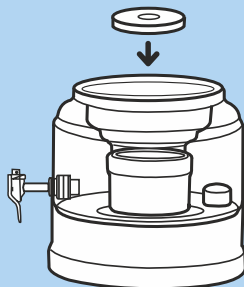

4. Place the alkalite diskette in the bio ceramic filter after washing.

How to assemble and use

C

How to assemble filters

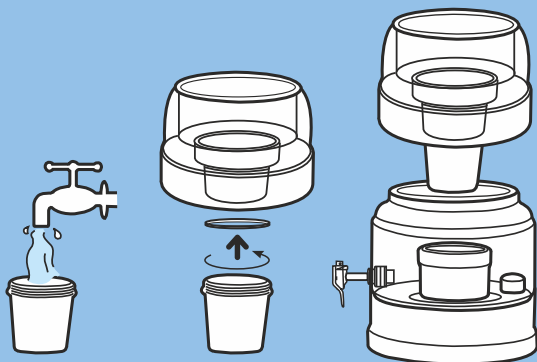

5. After 1 hour of soaking, take out the main filter from the water container, and wash it again by flushing water through the filter until no black or white small particles are coming from the filter. Install to the main funnel as shown.
6. Place the assembled main funnel on the glass pot.

Please check if the rubber ring (O-ring) of main filter is properly installed. This may cause a leak.

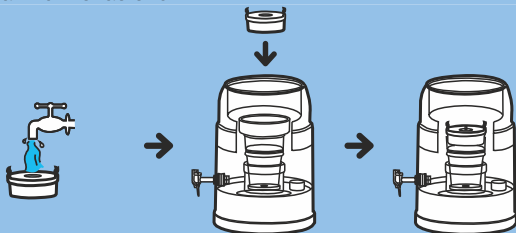

7. After 1 hour of soaking, remove the upper(1st stage) filter from the water container, and wash it again by flushing water through the filter until no black or white small particles are coming from the filter. Then install inside the main funnel as shown.
8. Place the micro cotton pad in the upper(1st stage)filter and place the micro cotton pad holder in place as shown.

How to assemble and use

C

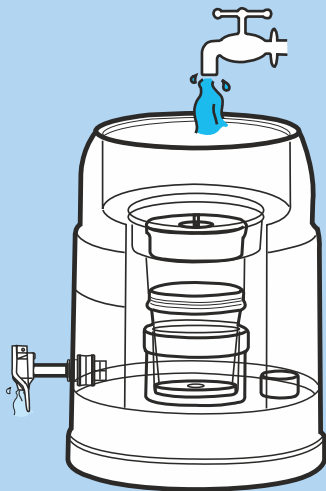

Finally, rinse out the entire Bio400 by filling 2 full pots of water. Drain out through the faucet. Now the Bio400 is ready to use.



1. Replace the upper(1st stage)filter per 6 months.
2. Replace the main filter per 18 months.
3. Replace the micro cotton pad per 14 days or when it turns yellow.

How to install tap outlet

D

Components of tap outlet



O-ring



Multi poles round magnet



O-ring



Multi poles round magnet



nut



tap outlet

Installation Method

01.

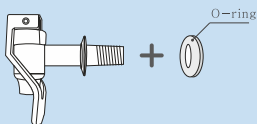

02.

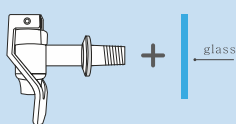

03.

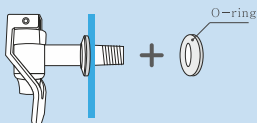

04.

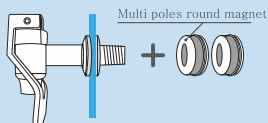

05.

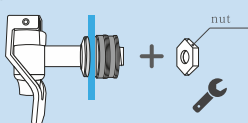

Tighten with wrench
but do not over tighten as you may break the glass

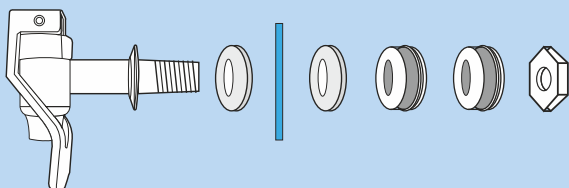
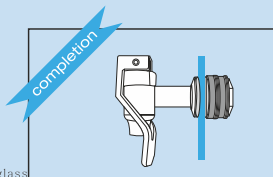

Important Reminders

1. Be sure to replace the filters as directed by your supplier or agent.
2. Do not leave the product near fire, stove, heat, etc.
3. Be sure to use only tap water. Do not use hot water or beverage.
4. Water from wells is not recommended for BMP 400
This may also shorten the lifespan.
5. Do not store the filtered water in aluminum ware or copper ware.
6. Glass Pot is fragile.
7. It is recommended to clean the Glass Pot every three months.
8. Keep the product clean.
9. Keep the bio ceramic filter and mineral main filter submerged in water.

Specification

Model	BMP 400	
Height	378mm	
Diameter	233mm	
Weight	5.06 kg(7.7kg when water is filled)	
Pot Capacity	5 liters	
Material	Pollution-free material	
Name of filter	Quantity	Lifespan of filter
Upper(1st stage)filter	6pcs.	3 months / each pc
Main Filter	2pc.	9 months / each pc
Bio Ceramic Filter	1pc.	Replacement is not required unless broken
Alkalite Diskette	1pc.	Replacement is not required unless broken
Sub Mineral Filter	1pc.	18 months
Micro Cotton Pad	80pc.	7 days/each pc or when it turns yellow

The recommended filter capacity and the recommended lifespan of filter parts stated above serve as a guide only. To ensure water quality, it is recommended to replace filters as mentioned above. However, lifespan of the filter parts is subject to quality of water used.

Waters Co., Ltd.

YOUIDO DEPT. BLDG.,36-2 YOUIDO-DONG YOUNGDEUNGPO-KU SEOUL, KOREA

Tel:(82)2-827-0631 Fax:(82)2-827-0634

www.waters.co.kr